

Audionor AS

Light J-Frame

All rights reserved by Expo Engineering.

The prepared documents and drawings are licensed for manufacturing the parts for the internal use by Audionor AS. Any reselling or serial production needs the permission of Expo Engineering!

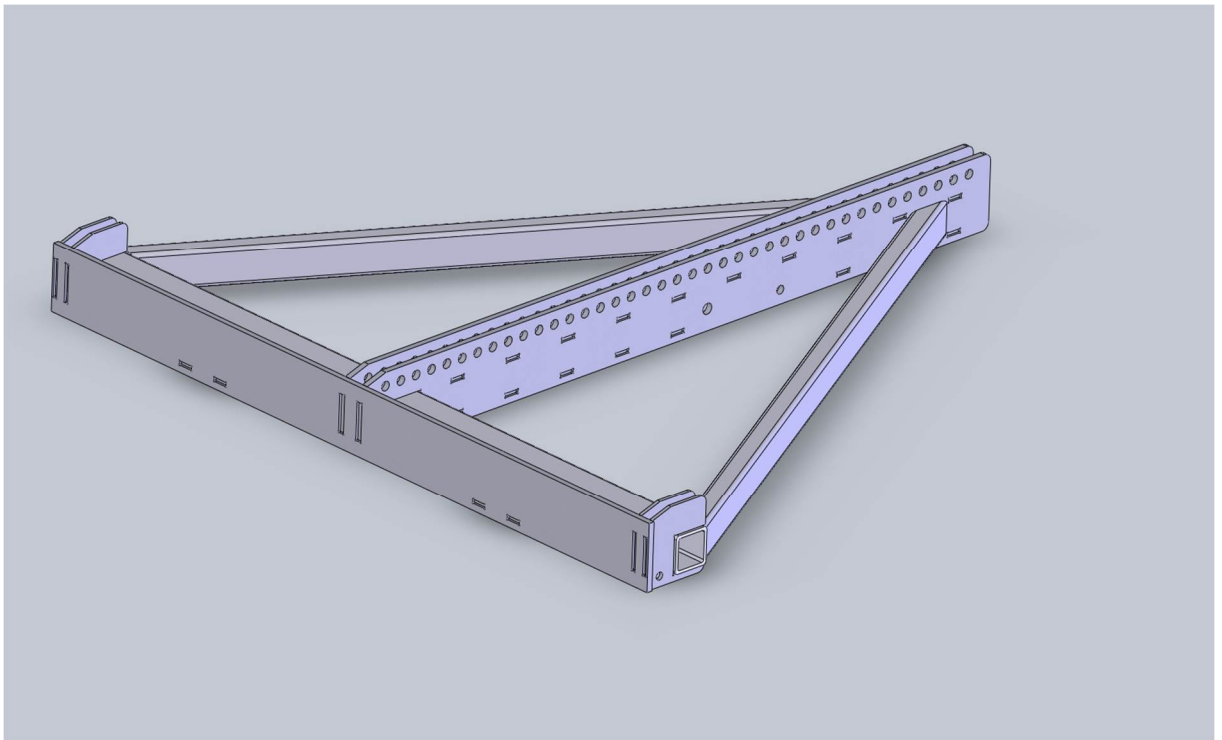

### **Basics for safe use**

The Flying Frame has been designed according German and European standards. The manufacturer must be certified for welding works according EN1090 or DIN 18800-7. Use only materials according the drawings with certifications according EN 10204 – 3.1.

Use only original pins, Load-adapters, hooks, and all other accessories from d&b audio. Always check the lifting situation of the d&b parts with the array calculator.

## Load Limits of the Flying Frame "Light J-Frame"

This is the maximum Load situation given by Audionor AS:

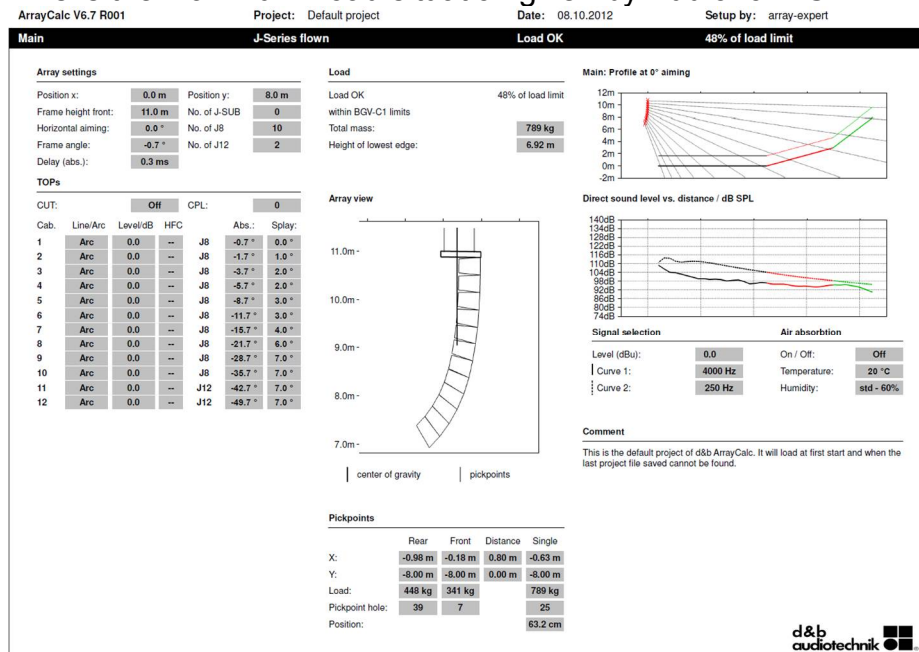

Maximum is 12 Boxes of J8/J12 each 63 kg.

Maximum curving is given in the print of the array calculator.

The maximum Load of front pick should never exceed 500 kg.

The maximum Load of rear pick should never exceed 600 kg.

The total Load should never exceed 800kg (12 boxes).

A single Pick is possible between front- and backlink up to 800kg, otherwise use 2 Picks.